



REGAN RIDGE LUXURY VILLAS

MURRYSVILLE, PENNSYLVANIA

DEVELOPER FUSTING MANAGEMENT CORP.

ARCHITECT WAY ARCHITECTURE + DESIGN PARTNERS

INSTALLER TONY FRANCIOSI

APPLICATION NEW CONSTRUCTION

TYPE RESIDENTIAL

YEAR 2023

PRODUCT SPECTRUM FAÇADES

FASTENING SYSTEM SPECTRUM EXPOSED SYSTEMS (ATS 710)

PHENOLIC PANEL DECORS USED TRESPA® METEON®



L21.5.1
LONDON
GREY

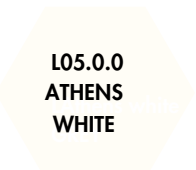

L05.0.0
ATHENS
WHITE



A90.0.0
BLACK

CASE STUDY - RESIDENTIAL

INTRODUCTION

The Regan Ridge project is an ambitious residential development located 20 miles east of Pittsburgh, designed by Way Architecture + Design Partners. This project aims to introduce a contemporary architectural style to a farmland community, serving as a precursor to a future corporate park. The project lays the groundwork for future expansion plans using Trespa Miteon materials.

Facade Design and Challenges

The project involved designing a three-story duplex condominium, which will be replicated across an 18-unit residential development. Each unit has a rooftop deck, an entertainment room, a private elevator, and an open main-level floor plan. The developer sought a contemporary design to contrast with the rural, suburban environment, creating a bold visual statement. The challenge was to ensure the modern design was engaging yet relatable to the scale of the surrounding houses, making it an attractive option for potential buyers in a traditional community.



Selection of Materials to Meet Design Challenges

The design team chose Trespa Miteon panels for their distinctive advantages.

- **Durability:** Known for their long-lasting weather resistance, these panels ensure the buildings withstand the elements, maintaining their aesthetic and structural integrity over time.
- **Color and Finish Options:** Trespa Miteon offers a variety of colors and finishes, allowing for creative flexibility in achieving modern geometric façades that match the developer's vision.
- **Benefits of Maintenance-Free Living:** The use of Trespa Miteon panels contributes to a maintenance-free lifestyle, offering residents more free time, less stress, and the elimination of exhausting outdoor maintenance. This advantage enhances the appeal of the development, providing more opportunities for residents to connect and engage with their community.

CASE STUDY - RESIDENTIAL

Project Satisfaction and Developer Feedback

Both the architect and the developer express satisfaction with the project outcomes. Way Architecture + Design Partners is pleased with the results, noting the successful integration of modern design elements into the rural setting. The developer is equally satisfied, particularly with the aesthetic appeal and performance of the Trespa Meteon panels, which have met their expectations.

Collaboration with ATS

The experience of working with Allied Technical Solutions & Spectrum Façades was high reflecting a positive and productive collaboration. ATS & Spectrum Façades provided comprehensive support throughout the project, from the design concept to the final specification and submittal process. The use of laser field verification ensured precision in the façade construction and panel layout, providing confidence to all parties involved. This innovative service, offered through a third-party vendor, highlights ATS & Spectrum Façades commitment to quality assurance and client satisfaction.

Future Outlook

The Regan Ridge project showcases the successful application of modern architectural design in a rural setting. Utilizing Trespa Meteon panels, the development achieves a balance between contemporary aesthetics and environmental resilience. As the second building installation progresses the project's innovative design and quality materials paved the way for future expansion and acceptance in the community.



SUSTAINABILITY

At the heart of our environmental product strategy, Spectrum focuses on four key elements:



DURABILITY

- Our main driver of environmental sustainability is durability.
- By needing fewer replacements, long-lasting products entail less use of resources, lower emissions of pollutants, and a smaller amount of waste than short-lifespan goods.
- Additionally, our products' long expected useful life is complemented by low maintenance levels.

LOW-CARBON MATERIALS

- Our phenolic panel inputs have robust Environmental Product Declarations (EPD) and are evaluated using Life Cycle Analysis (LCA).
- We use panels made from 70% wood fibers sourced from sustainable forests. As such, Spectrum products act as a natural source of carbon capture.



LOW CARBON MANUFACTURING PROCESS

Spectrum's manufacturing process focuses on reduction of CO² emissions through 3 key strategies.

- Sustainable sources of power.
- Lowering overall energy consumption.
- Reduction of waste through panel optimization.

END-USER SAFETY

- Spectrum products have low VOC (Volatile Organic Compounds) emissions, contributing to a healthier environment. Green Guard Gold certifications available.
- The inherent properties of phenolic panels do not contribute to mold or bacterial growth and are safe for food-grade applications.





SUSTAINABILITY

Spectrum Façade panels are made of 70% wood fiber. The raw material is both renewable and a natural carbon capture sourced from suppliers holding FSC or PEFCM certification. Complete Life Cycle Analysis (LCA) and Environmental Product Declarations (EPD) are available for our core components. Local production and fabrication in North America result in a lower overall carbon footprint. Electricity used in processing is generated primarily by low-carbon sources.

LOWER EMBODIED CARBON THAN OTHER FACADE SYSTEMS

Facade Wall Assemblies - Global Warming Potential (GWP kgCO₂e/sf)

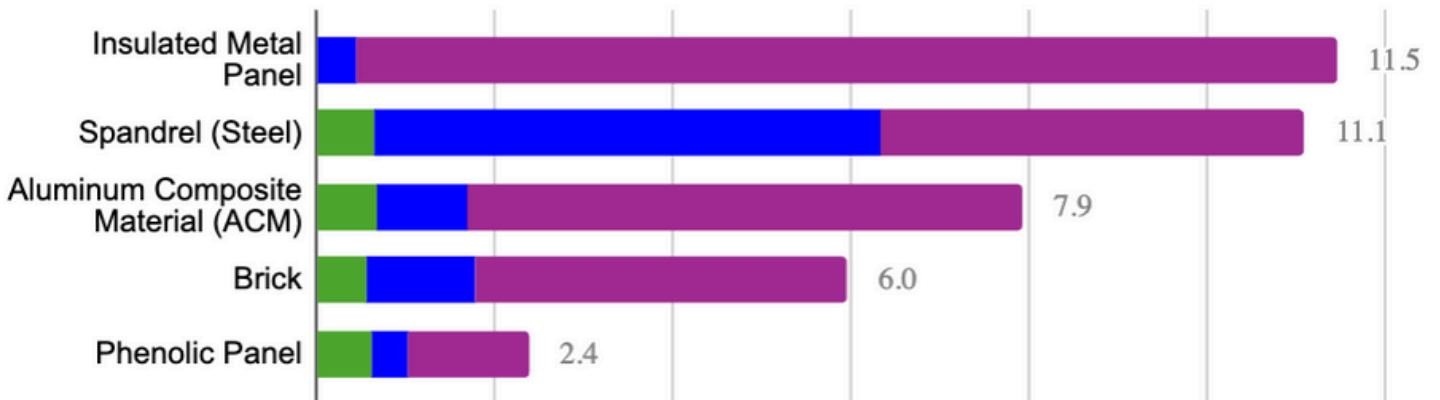

SOURCE: PAYETTE. KALEIDOSCOPE: EMBODIED CARBON DESIGN TOOL - JULY 2024

10 YEAR PRODUCT WARRANTY



ABOUT SPECTRUM

We Manufacture Solid Phenolic Architectural Products



FAÇADES

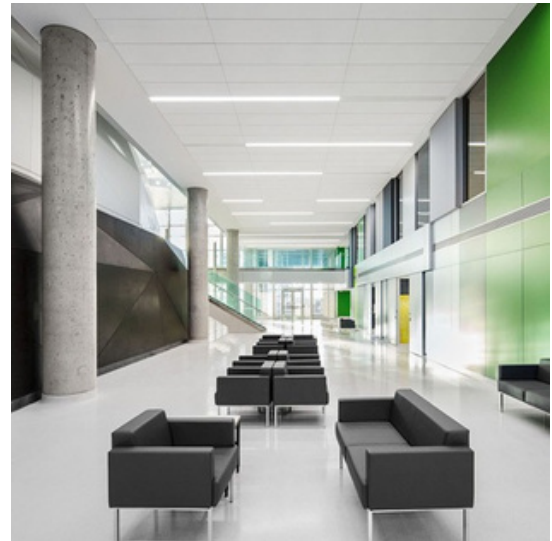

WALL LININGS



LOCKERS



SCIENTIFIC WORKSURFACES

We leverage the material advantages of solid phenolic panels to create products with a focus on design freedom, sustainability and category leading performance. Built to withstand the test of time, our solutions enhance the aesthetics of buildings and provide long-term value to building owners.

ESTIMATING@ATS-SALES.CA

1-855-444-0588

SPECIFICATIONS & DETAIL DRAWINGS AVAILABLE

SPECTRUM-BUILT.COM